

CREATIVE ART-VENTURE PROJECT

PART OF AN
INTERACTIVE
Scale Model
Build System
for Developing
Critical Thinking Skills

PAGO™
(pā-gō)

Character Building
INSTRUCTIONS

'Punch out with care and **identify** all my parts, then **pre-fold** them where indicated following the included illustrative instructions.'

Hmmm? Do you leave me in my unmarked 'Pristine Way' or do you give me some coloring and or graphic applications? Before or after my construction?'

STEP
1

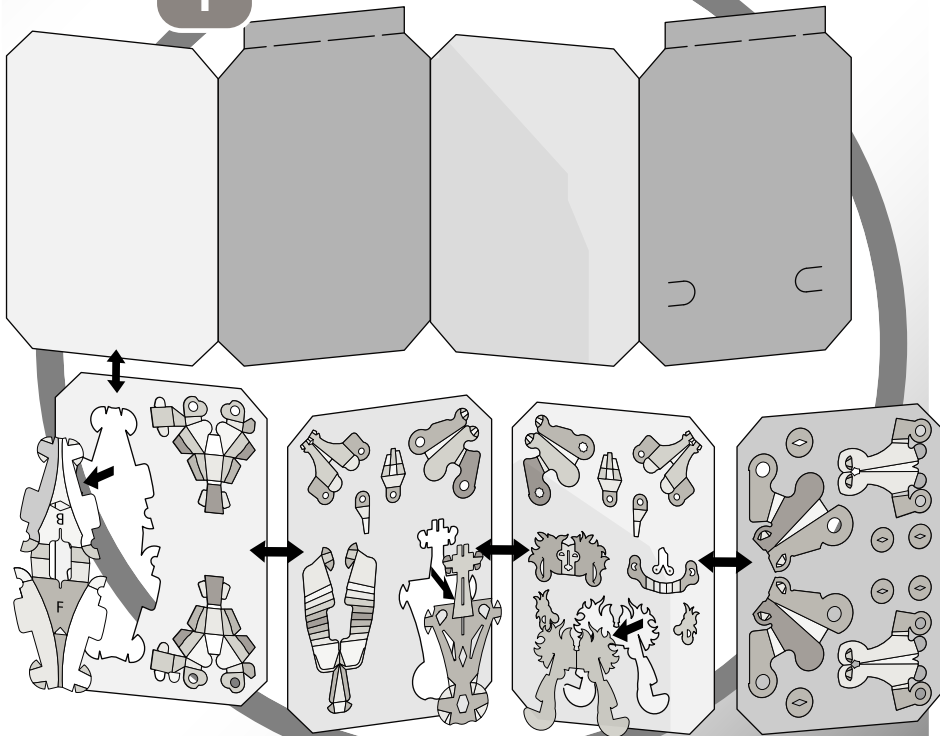

STEP
2

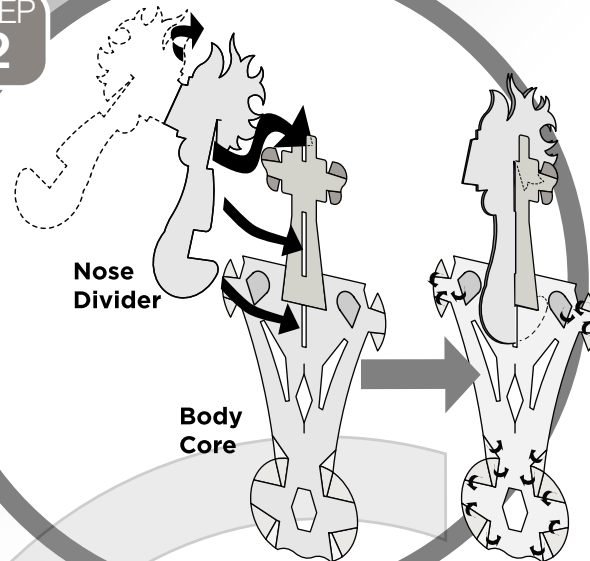

STEP
3

Note 'F' for Front
and 'B' for Back

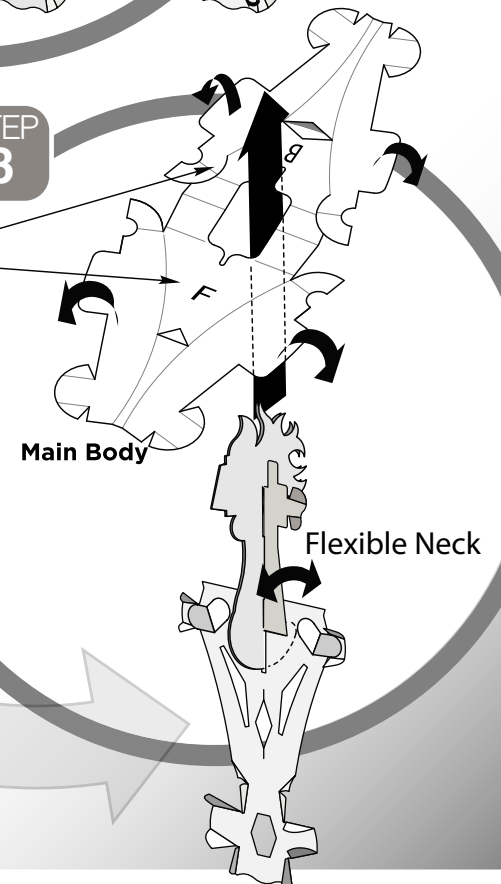

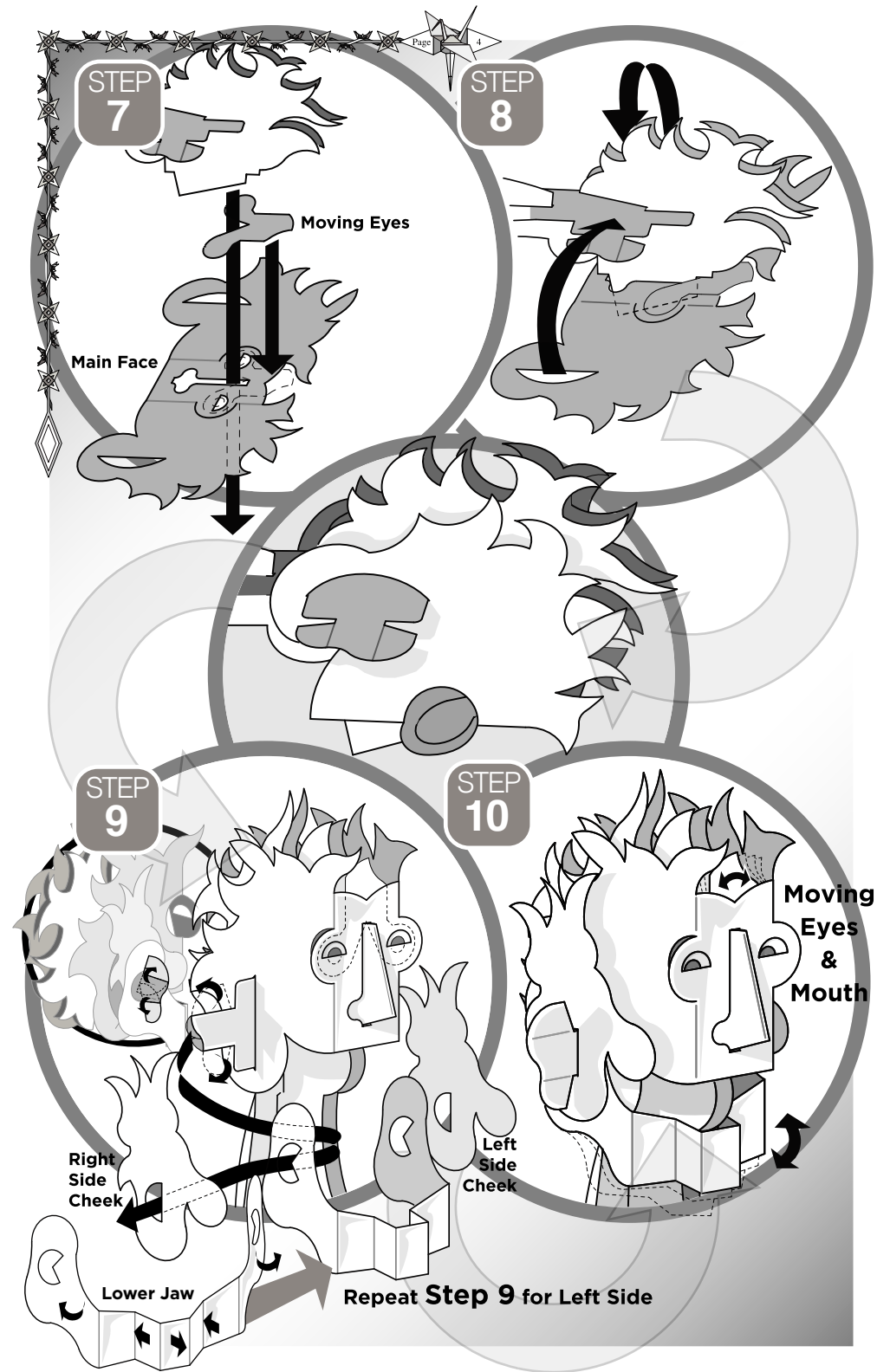
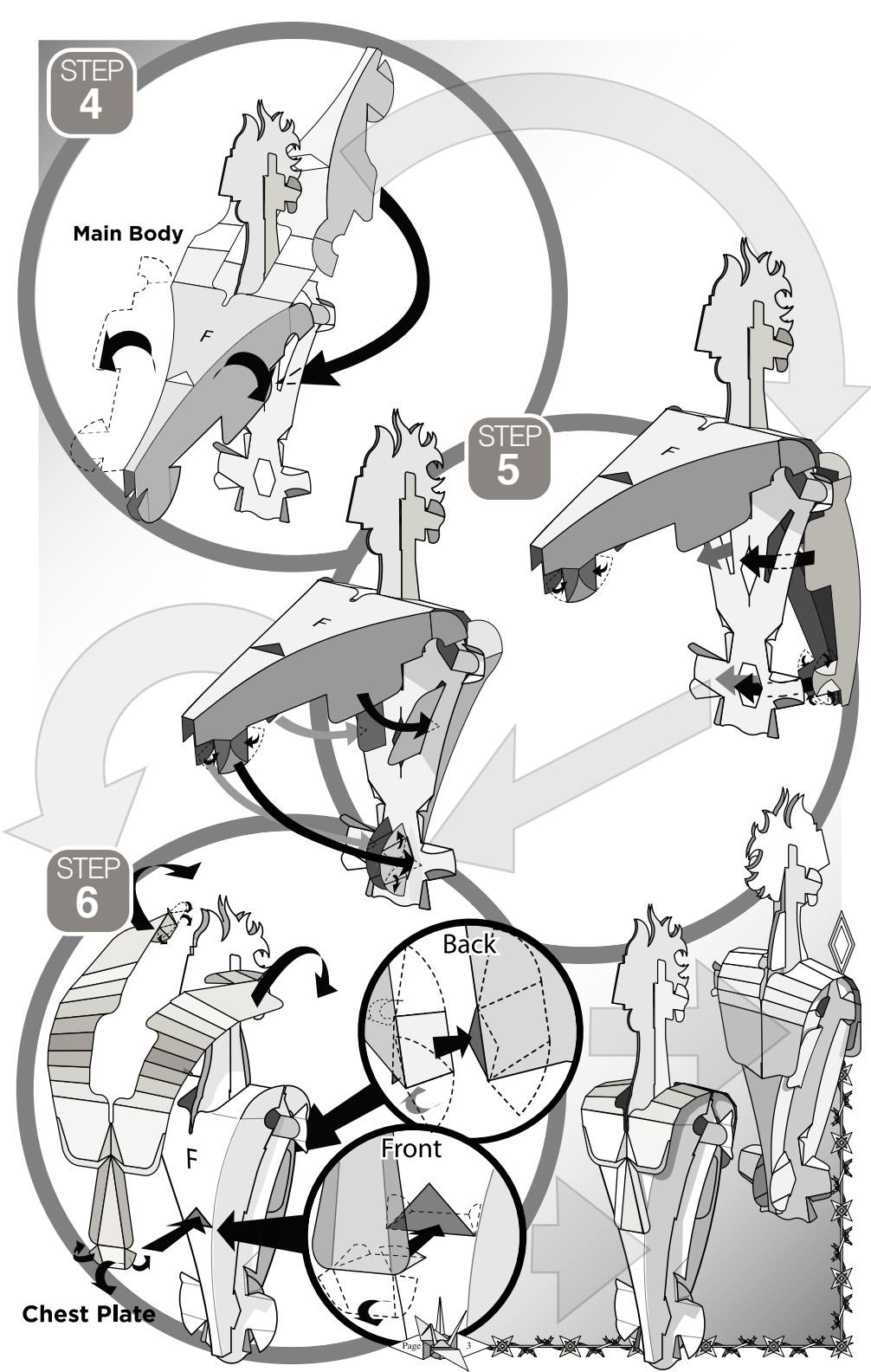

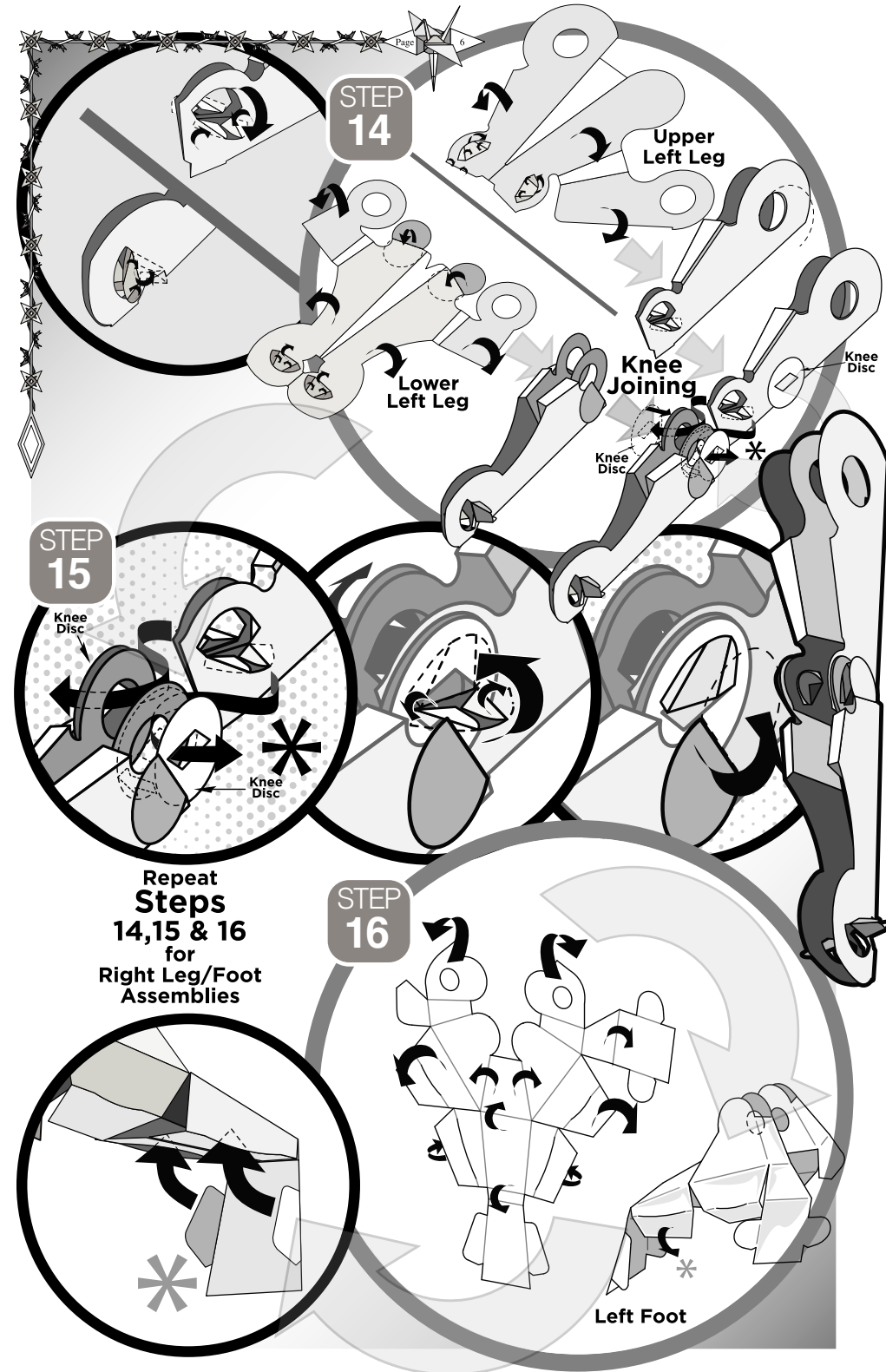
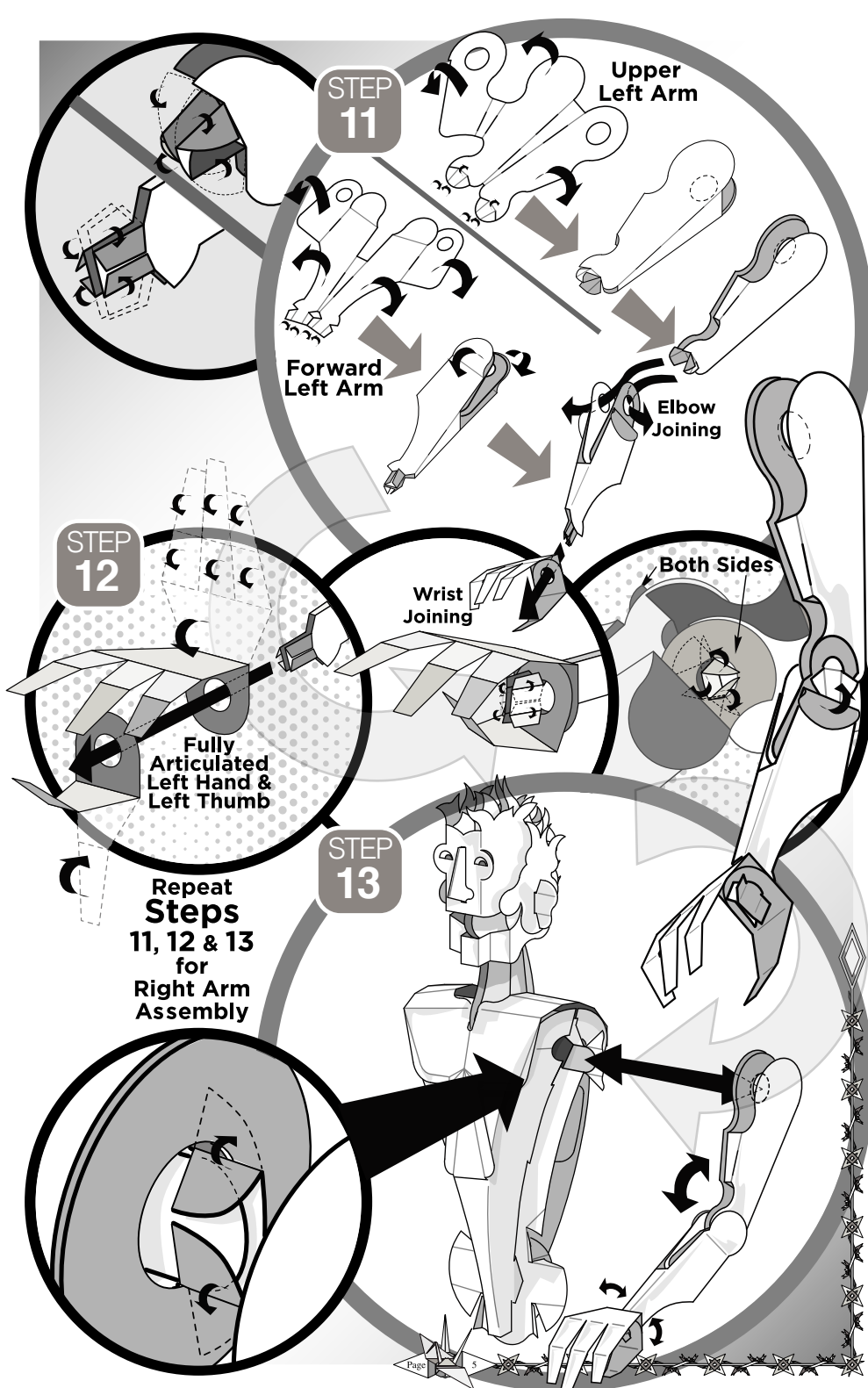

STEP
17

Upper
Left Leg

Lower
Left Leg

Ankle
Joining

Repeat
Steps
17 & 18
for
Right Leg/Foot
Assemblies

Left Foot

STEP
18

STEP
19

Hip Disc

Hip Disc

Repeat
Step 19
for
Right Side
Assembly

www.pagotoys.com

PAGO
Build
System
Give to Creativity™